

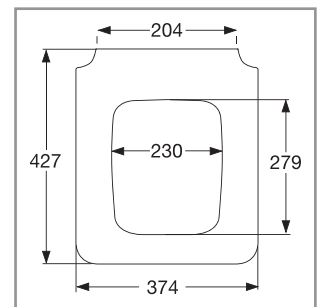

Toilet seat Lounge

Model

Lounge toilet seat with Soft Closing and Quick Release, incl. fixed hinge
SAP code: 100121998
KEA code: N379000013



Product Description

Lounge toilet seat in sandwich design made of colour ingrained duroplast with hinge in stainless steel
– incl. fixed hinge in stainless steel
– centre distance: 204 mm
– load of ring seat: 240 kg
– 10 year guarantee(*damper*)
– 2 year guarantee(*seat and cover*)

Colour Range

White

Hinge Finish

Stainless steel

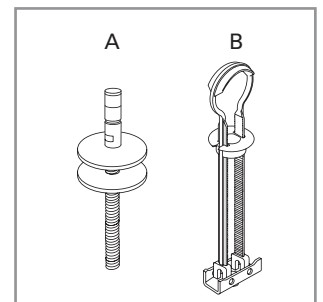

Spare Parts

A) Fixed hinges (100129106/N499817005)
B) Spare part for fixed hinge (100125027/N499816968)
C) Buffer set, complete (100129109/N377001074)
D) Damper set (100129115/N484000003)

Cleaning Instructions

Use a mild soap solution to clean the seat, and take care that the seat and hinges are not left damp. Dry off any residual water or cleaning agent with a soft cloth. Avoid contact of the seat and hinges with abrasive, corrosive or chlorine-based cleaners, as they may cause damage.

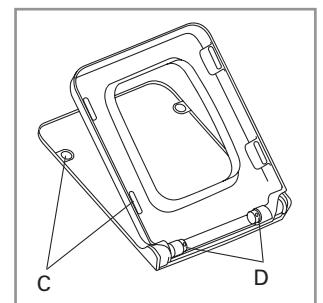

Toilet seat Lounge

Instruction manual

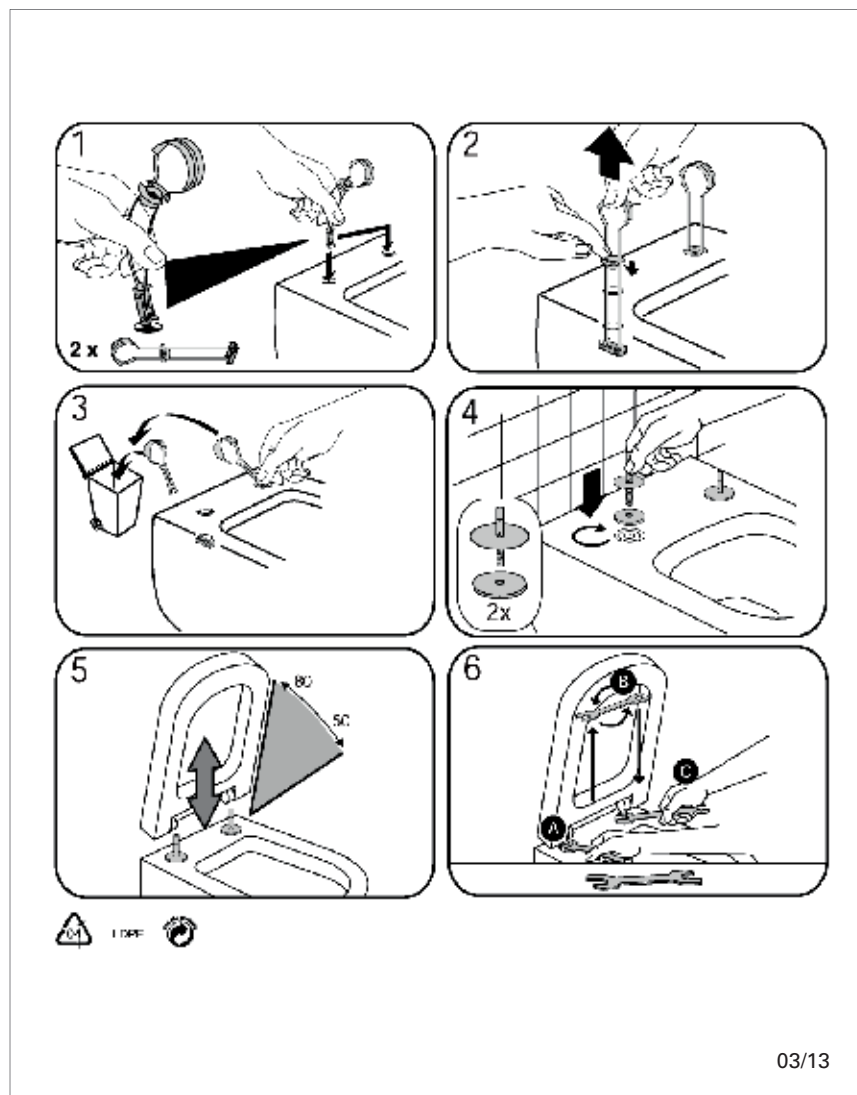

Material Description

TOILET SEAT: The material is colour ingrained duroplast (UF A 10 = urea formaldehyde) that contains no environmentally hazardous substances. The body consists of approx. 50% urea (NH_2CONH_2), approx. 25% cellulose and approx. 25% formaldehyde (HCHO), as well as small amounts of various fillers and additives.

BUFFERS: EVA (copolymer made of ethylene and vinyl acetate).

MOUNT/HINGE: Stainless steel.

Guarantee

The guarantee includes faults or defects in the material of our products within a periode of 10 years. Products subject to minor technical modifications and design deviations E. & O.E.

NOKEN DESIGN

Carretera CV-20 km 2, 12540 Villarreal, Castellón, Spain
Telephone: +34 964 50 64 50
Fax (when calling from Spain): +34 964 50 67 90
Fax (when calling from abroad): +34 964 50 67 91
e-mail: noken@noken.com · export@noken.com

noken
PORCELANOSA Grupo