

# Installation Instructions

LOW LEVEL / CLOSE COUPLED-DUAL FLUSH VALVE

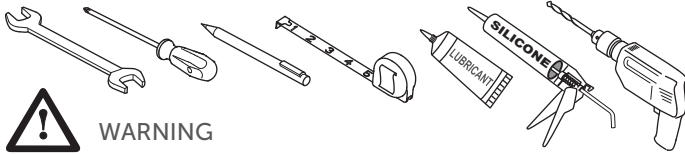

**WARNING**

Do not use or drop any chlorine or chemical related components into the cistern or closet bowl. Use of such products will:  
 (a) Result in damage to tank components, and may cause flood and property damage.  
 (b) Void warranty.

## Important Notes

There may be a flow restrictor pre-installed in the inlet valve, which should be removed for installations with very low supply pressure. Please see the inlet valve instructions supplied separately. Take care to avoid cross-threading. Do not over-tighten back-nuts. Care should be taken when drilling walls and floors to avoid any sunken wires or pipes. Servicing valve: The Water Regulations have a requirement to fit a servicing valve adjacent to the cistern (not supplied). Do not over-tighten nuts or cistern / bowl may crack.

## Parts Required (not supplied)

Brass Screws and Fixing Plugs to secure the cistern and closet bowl.

## Operating Water Pressure For Inlet Valve

0.2 Bar - 8.0 Bar

## Cistern assembly

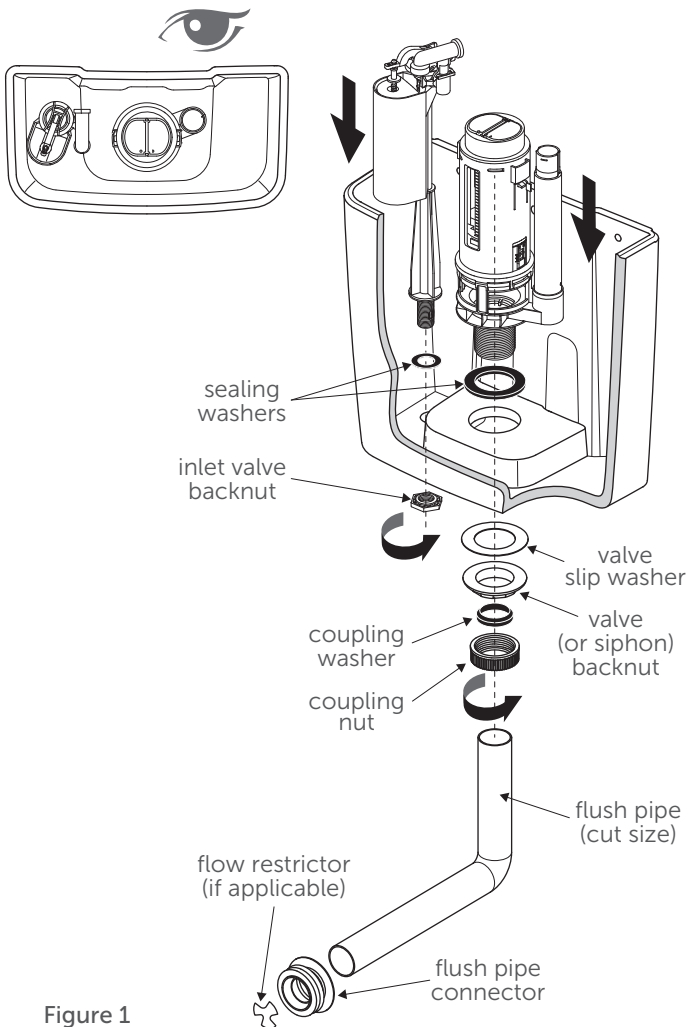
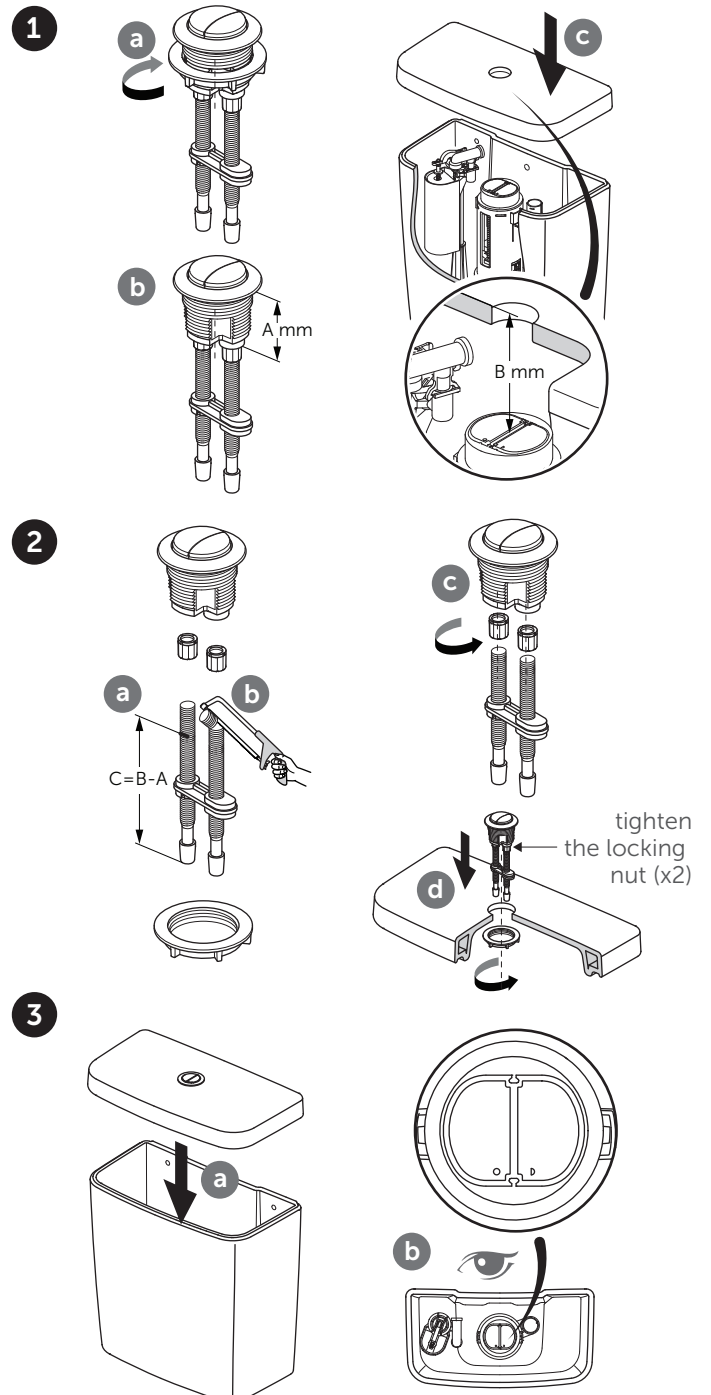

Figure 1

## Button installation if required

Measure the distance from the top of the cistern lid through the button hole to the top of the valve. Loosen the button rod nuts and adjust both button rods to the measured dimension. Retighten the locking nuts. Fit the push button into the cistern lid with the two rods parallel to the back of the cistern and secure with nut. If the rods are adjusted too long the valve will stay open. Too short and the valve may not flush. Fit cistern lid.



# Low level

## INSTALLATION

Diagrams shown are pictorial only and outlines of items shown may not represent the actual pieces supplied.

Fit inlet valve and outlet valve (or siphon) into cistern, refer to separate instruction where provided. Ensure rubber sealing washers are positioned inside of cistern, (Fig. 1), and moving parts do not foul the cistern wall or other fitments.

Check outlet valve settings and overflow position. Refer to settings table.

Position and fix cistern support brackets to the wall, (Fig. 2). Brackets are to be located within the recess at the back of the cistern, (bracket fixings not supplied).

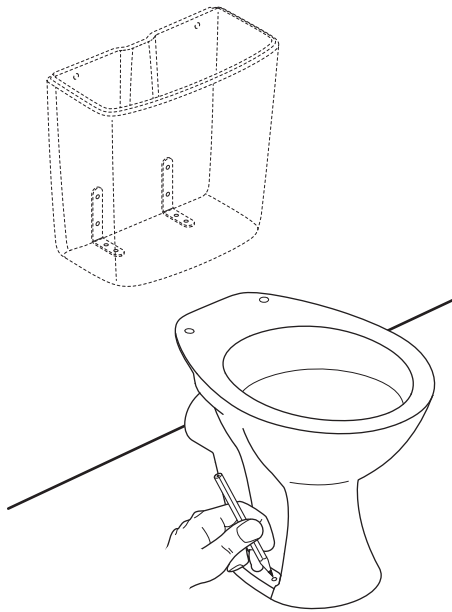

Figure 2

Position closet bowl and mark closet screw holes positions on floor. Remove closet bowl and drill floor to suit fixings, (not supplied) (Fig. 2).

Locate cistern on cistern support brackets (Fig. 3) and mark screw hole positions on wall. Remove cistern and drill and plug wall. Reposition cistern and screw to wall with No. 12 RH wood-screws (not supplied).

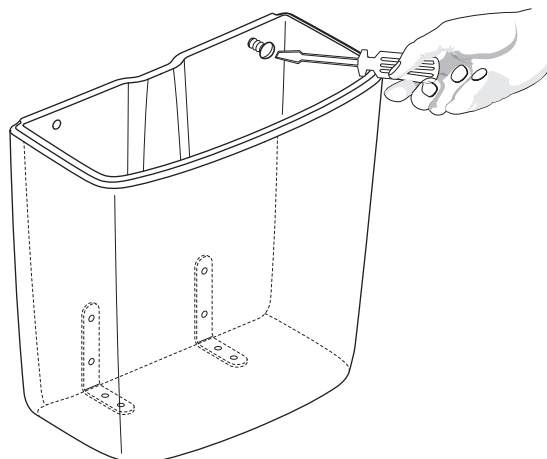

Figure 3

Insert flush pipe connector (Fig. 4) into closet bowl inlet, if unit is supplied with flow restrictor, then this is placed into pan inlet before flush pipe connector.

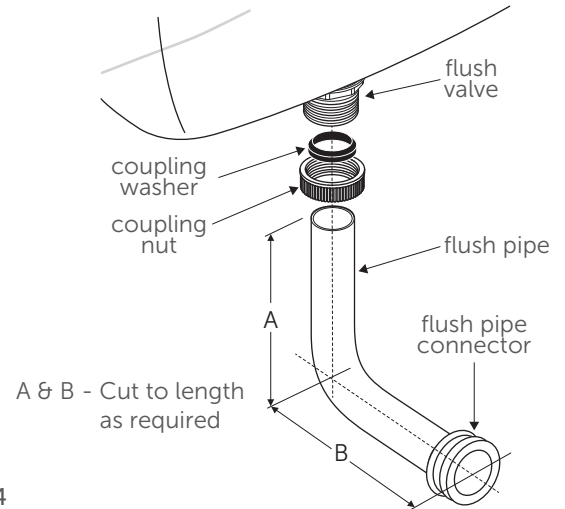

Figure 4

Reposition closet bowl towards the wall (Fig. 5) and its marked screw hole position. Insert flush pipe into the flush pipe connector. Place coupling nut and coupling washer on to the vertical end of the flush pipe. Insert flush pipe into the outlet valve and tighten the coupling nut with coupling washer in place.

Note: Flush pipe may need cutting down to suit arrangement.

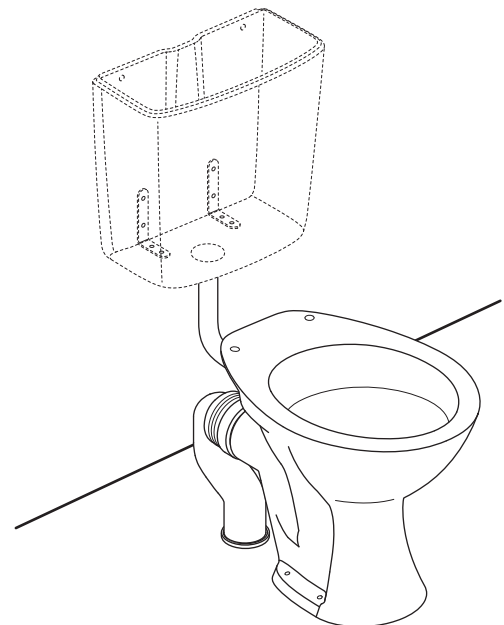

Figure 5

Screw closet bowl to floor with No. 12 RH woodscrews (not supplied).

Fit outlet valve push button assembly (where applicable) to cistern lid. Refer to separate push button instructions.

Connect closet bowl outlet to the soil system and connect inlet valve to water supply pipework and fill cistern.

Adjust fill valve to give correct water level as marked on cistern.

Flush the closet suite and check connections for leaks.

# Close coupled

## INSTALLATION

Diagrams shown are pictorial only and outlines of items shown may not represent the actual pieces supplied.

Fit inlet valve and outlet valve (or siphon) into cistern, refer to separate instruction where provided. Ensure rubber sealing washers are positioned inside of cistern, (Fig. 1), and moving parts do not foul the cistern wall or other fittings.

Check outlet valve settings and overflow position. Refer to settings table.

Position closet bowl and mark closet screw holes positions on floor (Fig. 6).

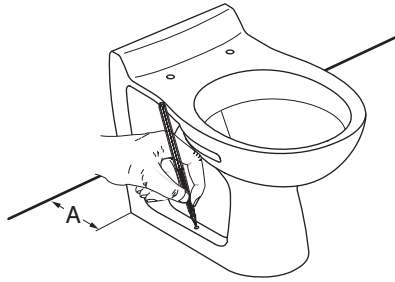

Suite	A
Contour 21 Schools 305	150
Contour 21 Schools 355	150

Figure 6

Before moving closet bowl, position the cistern, resting it on the rear of the closet and mark the cistern fixing screw hole positions on the wall, (Fig. 7).

Remove the cistern and closet bowl and drill floor and wall to suit fixings (not supplied).

Fit outlet connector (not supplied) to waste pipework ready to take closet.

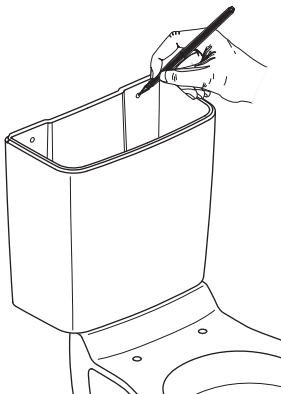

Figure 7

The flush pipe is to be cut down as required, (Fig. 8).

Insert flush pipe connector (Fig. 8) into closet bowl inlet, if unit is supplied with flow restrictor, then this is placed into pan inlet before flush pipe connector.

Place coupling nut and coupling washer on to the vertical end of the flush pipe.

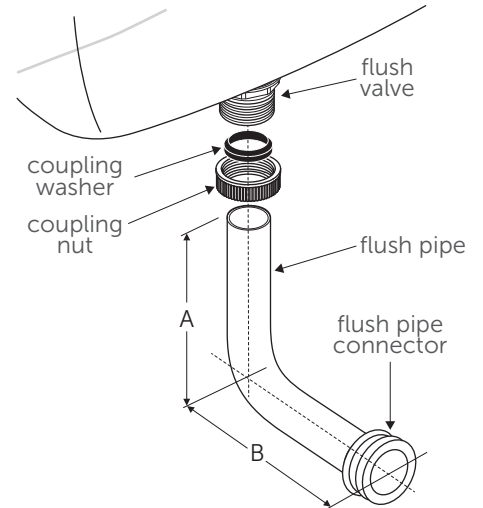

Figure 8

Reposition the cistern and insert flush pipe into the outlet valve and tighten the coupling nut with coupling washer in place.

Reposition closet bowl towards the wall (Fig. 9) and its marked screw hole position.

Note: This may be a 2 man operation.

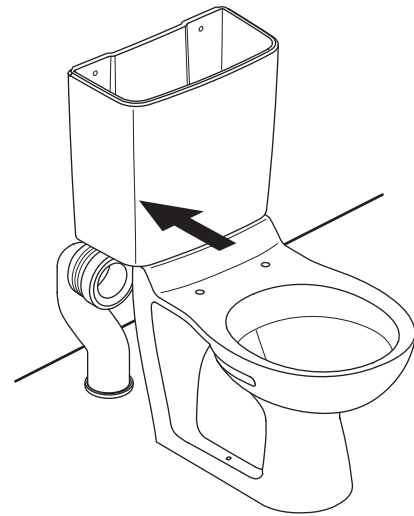

Figure 9

Screw closet bowl to floor with No. 12 woodscrews (not supplied).

Secure cistern to wall with No. 12 wood-screws (not supplied).

Fit outlet valve push button assembly to cistern lid. Refer to separate push button instructions.

Connect inlet valve to water supply pipework and fill cistern.

Adjust fill valve to give correct water level as marked on cistern.

Flush the closet suite and check connections for leaks.

# Outlet valve settings

If installed, turn outlet valve body anticlockwise and lift, parting it from outlet valve seat. Adjust valve settings to chart below by moving adjusters up or down.

## IMPORTANT NOTE



Not all closet bowls are designed to flush at 4/2.6 litre. Check pan performance details before setting valve at these settings.

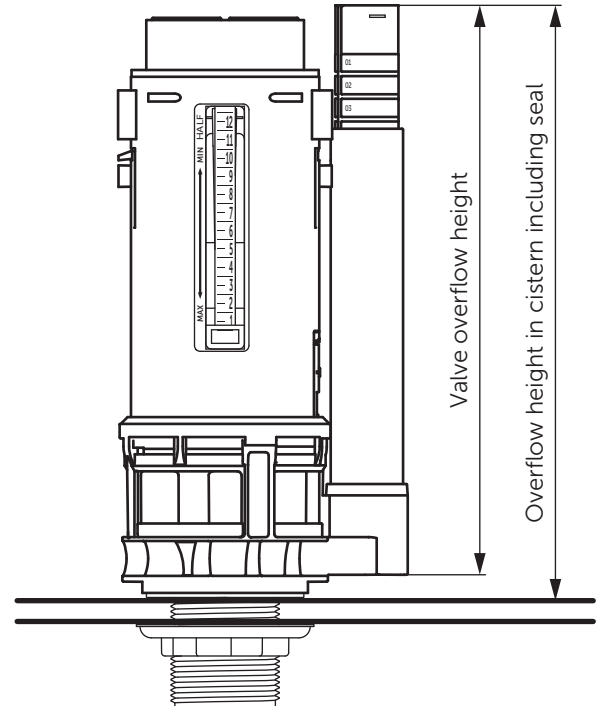
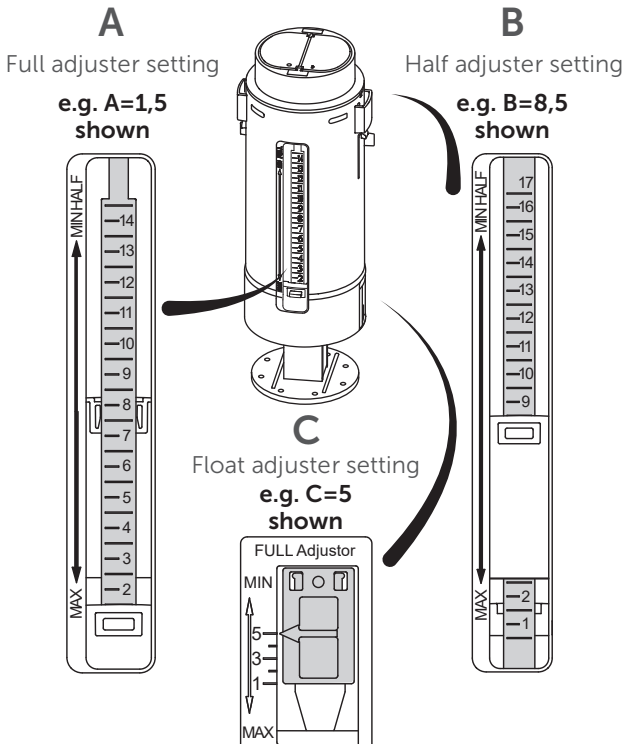
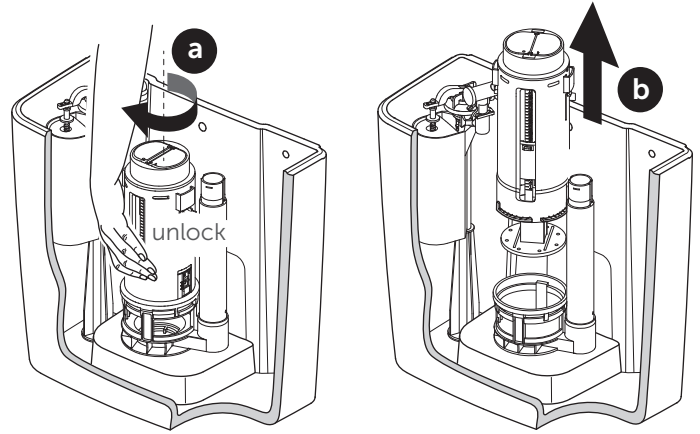

Cistern type	Cistern SKU code	Dual flush volume	Flush settings			Overflow adjustment	
			Full flush float	Part flush float	Full adjuster	Valve O/F height (mm)	O/F height when fitted (mm)
Sandringham 21 low level	E876101	6/4 Litre	0.5	5	5	225	235
Contour 21 schools	S306401	6/4 Litre	1	5.5	5	225	235
	S369401	4/2.6 Litre	5.5	9	5	225	235

For reference these valve settings are shown on:



<https://www.idealspec.co.uk/cistern-flush-valve-settings>

Illustration may not reflect item as supplied.

All cistern components must be installed in accordance with UK water regulations. If in doubt please consult a suitably qualified professional.

## CUSTOMER CARE HELPLINE

# 01482 496318

FAX LINE 01482 499611

email: [customer care@idealstandard.com](mailto:customer care@idealstandard.com)

4154

ver. 6.0/09.22

EEM34415467

ver. 6.0/09.22